

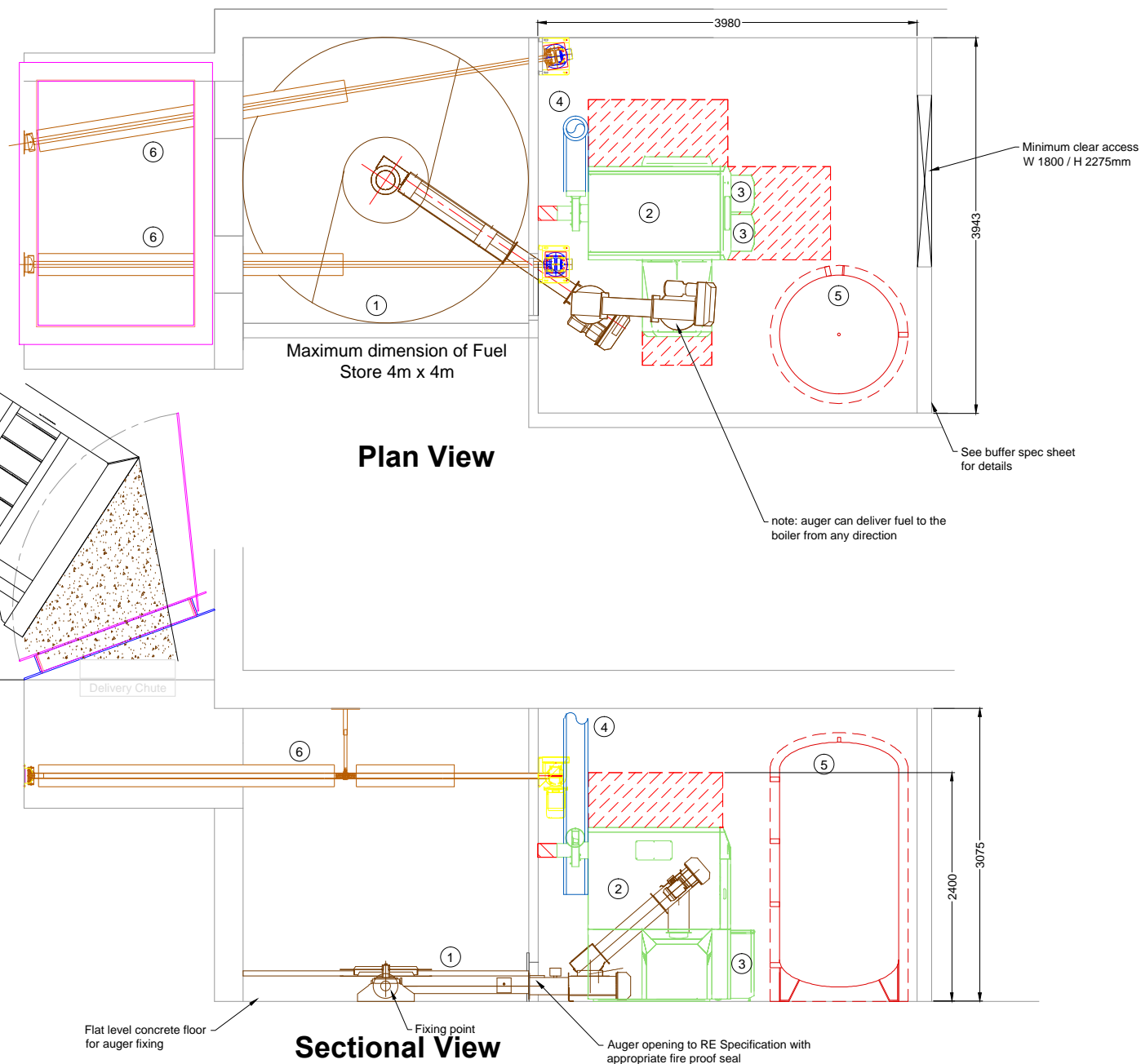

## Plan View

## Sectional View



### Bill of materials:

- ① Spring agitator fuel feeding system
- ② Herz FireMatic wood chip/pellet boiler
- ③ Removable ash bins
- ④ Chimney riser
- ⑤ Buffer tank
- ⑥ Filling Screws

### Supporting documentation:

- RE Flue design guide
- RE buffer tank specification sheet
- RE buffer tank control description and sizing guide
- Boiler data sheets
- Cyclone grit arrestor data sheet
- Wiring diagrams
- RE Hydraulic schematics
- RE design details
- RE Chip fuel store design guide
- RE Pellet hopper design guide

Plinths are not required for the boilers or cyclone, provided there is adequate protection against flooding

Rural Energy provides this drawing for the purposes of locating the heating system and ancillary equipment, but takes no responsibility for the design of the fuel store or the plant room in any respect

### Drawing Name

EXAMPLE LAYOUT  
Firematic Boiler. Chips/Pellets  
Below Grd Bunker, Integrated fuel  
store with filling screws

### Boilers

Herz FireMatic 130/151/180/191kW

### Drawing Number

RE\_028-130-151-180-199.V1

### Scale @ A1

nts

### Designed by

PM

### Date

04.04.12